

S INCH**Bore Reducers**

■ INCH TO INCH REDUCTION

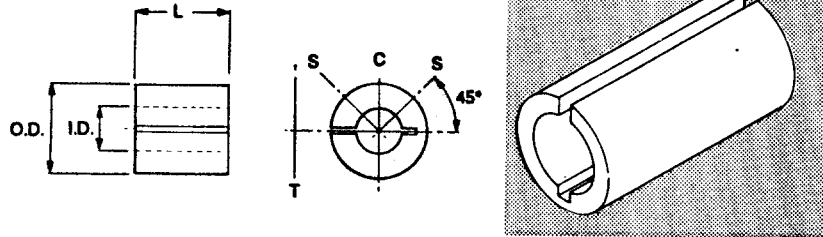

Installation Recommendations: S = set screw positions in hub
 C = for single set screw fastening
 T = for tangential screw in clamp hub

MATERIAL: Aluminum

Catalog Number	O.D. +.0005 -.0010	I.D. +.001 -.000	L	Catalog Number	O.D. +.0005 -.0010	I.D. +.001 -.000	L
A 7A30-251203	.2500	.1250	3/8	A 7A30-372507	.3750	.2500	7/8
A 7A30-251204			1/2	A 7A30-372508			1
A 7A30-251205			5/8	A 7A30-373104			1/2
A 7A30-251803	.1875	.1875	3/8	A 7A30-373105	.3125	.3125	5/8
A 7A30-251804			1/2	A 7A30-373106			3/4
A 7A30-251805			5/8	A 7A30-373107			7/8
A 7A30-311803	.3125	.1875	3/8	A 7A30-373108	.5000	.3125	1
A 7A30-311804			1/2	A 7A30-503104			1/2
A 7A30-311805			5/8	A 7A30-503105			5/8
A 7A30-311806			3/4	A 7A30-503106			3/4
A 7A30-311807			7/8	A 7A30-503107			7/8
A 7A30-312503	.2500	.2500	3/8	A 7A30-503108	.3750	.3750	1
A 7A30-312504			1/2	A 7A30-503704			1/2
A 7A30-312505			5/8	A 7A30-503705			5/8
A 7A30-312506			3/4	A 7A30-503706			3/4
A 7A30-312507			7/8	A 7A30-503707			7/8
A 7A30-372504	.3750	.2500	1/2	A 7A30-503708	.5000	.5000	1
A 7A30-372505			5/8	A 7A30-503710			1-1/4
A 7A30-372506			3/4				

NOTE: Bore reducers with thicker walls may have slot extending into opposite wall for additional flexibility.

S INCH**Bore Reducers**

■ INCH TO METRIC REDUCTION

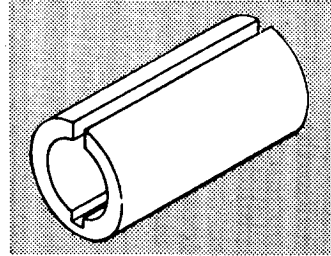
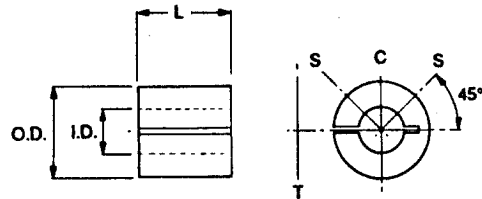

Installation Recommendations: S = set screw positions in hub
 C = for single set screw fastening
 T = for tangential screw in clamp hub

MATERIAL: Aluminum or Brass where noted*

Catalog Number	O.D. +.0005 -.0010 in.	I.D. +.025 -.000 mm	L in. (mm)	Catalog Number	O.D. +.0005 -.0010 in.	I.D. +.025 -.000 mm	L in. (mm)	
A 7A30-250309	.2500	3	.354 (9)	A 7A30-370612	.3750	6	.472 (12)	
A 7A30-250312			.472 (12)	A 7A30-370616			.625 (16)	
A 7A30-250409		4	.354 (9)	A 7A30-370619			.750 (19)	
A 7A30-250412			.472 (12)	A 7A30-370622			.865 (22)	
A 7A30-250416			.625 (16)	A 7A30-370812			.472 (12)	
A 7A30-250509			.354 (9)	A 7A30-370816			.625 (16)	
A 7A30-250512		5	.472 (12)	A 7A30-370819		.750 (19)		
A 7A30-250516			.625 (16)	A 7A30-370822		.865 (16)		
A 7A30-250519			.750 (19)	A 7A30-500812		.472 (12)		
* A 7B30-250609			.354 (9)	A 7A30-500816		.625 (16)		
* A 7B30-250612		6	.472 (12)	A 7A30-500819		.750 (19)		
* A 7B30-250616			.625 (16)	A 7A30-500822		.865 (22)		
* A 7B30-250619			.750 (19)	A 7A30-501012		.472 (12)		
* A 7B30-250622			.865 (22)	A 7A30-501016		.625 (16)		
A 7A30-310609			.3125	6		.354 (9)	A 7A30-501019	.750 (19)
A 7A30-310612						.472 (12)	A 7A30-501022	.865 (22)
A 7A30-310616	.625 (16)	A 7A30-501212			.472 (12)			
A 7A30-310619	.750 (19)	A 7A30-501216			.625 (16)			
A 7A30-310622	.865 (22)	A 7A30-501219			.750 (19)			
A 7A30-370512	.3750	5			.472 (12)	A 7A30-501222	.865 (22)	

* Brass

NOTE: Bore reducers with thicker walls may have slot extending into opposite wall for additional flexibility.